

The last bastion of privacy, a space of peace and tranquillity, your Bathroom
 Enjoy the look and feel of our European Bathroom fittings and fixtures.
 Designed and made to the highest International and Australian standards.



HYDROTHERM TUBE - SERIES TOWEL RAIL



Single Tube Model
 50mm ϕ x 900mm
 High Polished Chrome

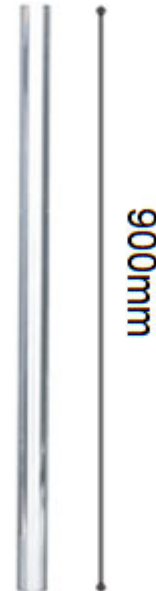

Single Tube Model
 50mm ϕ x 900mm
 High Polished Chrome

SYDNEY
 Woollahra
 163 Edgecliff Road
 Woollahra NSW 2025
 T 02 9386 9809

Crows Nest
 113A Willoughby Road
 Crows Nest NSW 2065
 T 02 9460 6111

MELBOURNE
 Richmond
 229 Swan Street
 Richmond VIC 3121
 T 03 9428 9996

QUEENSLAND
 Fortitude Valley
 Shop 2, 826 Ann Street
 Fortitude Valley QLD 4006
 T 07 3852 6363

FEATURES	
Replaceable Element	Heating element easily replaced
Space Versatility	Tube rail possess unique ability to be mounted Vertically or Horizontally, single or multiple
Copper Tube	Ensures ultimate thermal conductivity and radiation. Note: arms do not move independently
Local Product	100% Australian owned and manufactured

SPECIFICATIONS	
Model	Electric / Non - electric
Materials	Made entirely from Copper Tube with Brass Fittings
Element	Low wattage, replaceable water element
Power Cable	Through wall bracket - Left or Right Side
Safety rating	IPX5 (allows for installtion in zone 1 & 2 of bathroom)
Finish	High Polish Chrome Plate
Standards	AS/NZS:3350

Warning:
 This appliance is not intended for use by young children or infirm persons without supervision.
 Young children should be supervised to ensure they do not play with this appliance

Caution:
 Towel Rail must be installed so that the bottom rail is at least 600 mm above the floor to avoid a hazard for children.
 The cord extension set must be positioned so that it is not subject to splashing or ingress of moisture .
 The supply shall have means for disconnection with an air gap in all active conductors incorporated in the fixed wiring according to the Wiring Rules in AS/NZS 3000:2000



As part of ACS commitment to quality products. Information provided in this data sheet is representative of the actual product available at the time of printing. Due to our commitment to continuous product design and development, the designs and specifications depicted are subject to change without notice. Please confirm all particulars with your ACS sales consultant prior to purchase. Each product is covered by a limited warranty. Please see our website for full terms and conditions. This drawing remains the property of ACS and should not be copied or distributed without ACS consent. © 2010 All Dimensions are approximate in mm and are not to scale.

Fig 1.

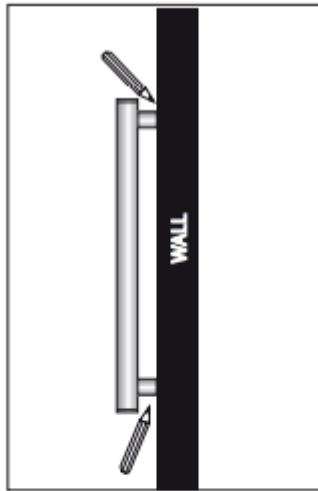

Hold Towel Rail in desired position against wall, with a pencil draw an outline around both bracket arms. Fig 1.

Take brass bracket insert and place against wall in outlined circle. Feed wall cable through appropriate hole, using a pencil mark the centre of screw hole and cross it for accuracy. Mark screw hole for second brass bracket insert. Fig 2.

Drill screw holes for both brackets, insert nylon plug into wall (if applicable). If tiled wall installer MUST use a DIAMOND HEAD drill bit. Position wall bracket so that GRUB SCREW HOLES face inwards. Fig 2.

A qualified electrician must then connect towel rail element to existing wall cable.

Fig 2.

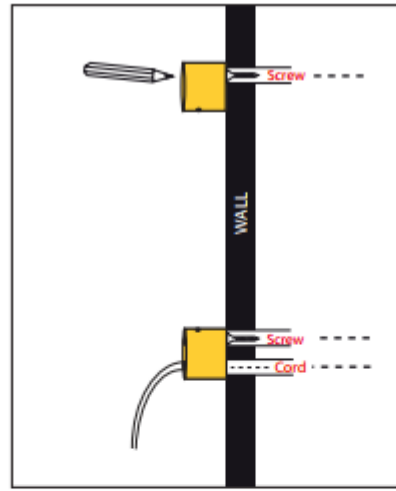

Please ensure that the measurements are taken accurately and that the screw is in a stud or noggin to provide support. DO NOT overtighten screws.

Please ensure a DIAMOND HEAD drill bit is used to drill screw and cord holes into tiled wall.

Hydrotherm take pride in the fact that all rails are individually hand made. Due to this fact some measurements may not be exact. PLEASE READ INSTRUCTIONS CAREFULLY and do not force towel rail into bracket if position of wall flange is not accurate.

Fig 3.

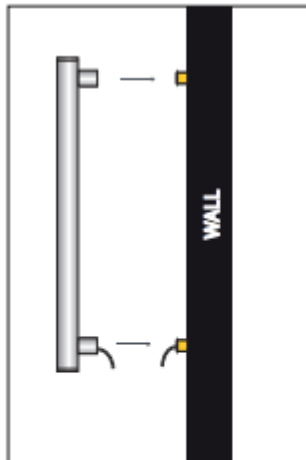

Place Towel Rail in correct position over mounted brackets, secure unit in place by tightening grub screw on inside of each bracket arm with Alan key provided. Fig 3. and Fig 4.

Fig 4.

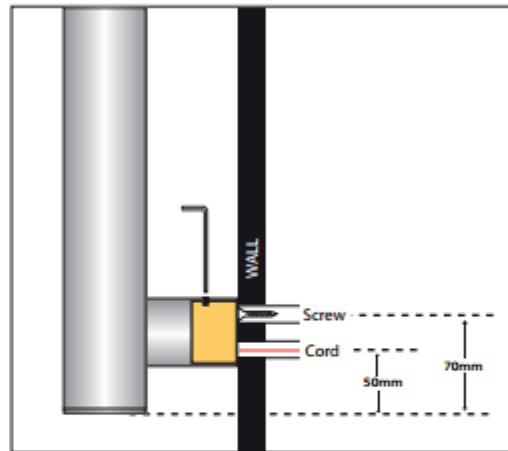

****INSTALLER MAY CHOOSE NOT TO USE SCREW IF NOT SUITABLE FOR APPLICATION**

DO NOT OVERTIGHTEN SCREW - LEAVE SLIGHT ADJUSTMENT OF THE FLANGE (SLACK) TO ENABLE MOVEMENT WHEN THE TOWEL RAIL IS POSITIONED.



REPLACING ELEMENT

Replacing an old element is a very simple process. All electrical wiring must be carried out by a licensed electrician.

There are Six Basic Steps:

1. You will need to obtain a 22mm tap spanner. Remove towel rail from brackets (if already installed).
2. On the side with the element cable remove push-on cap, and pull element cable through end.
3. Feed cable through spanner until you reach element hex nut.
4. Loosen element with spanner and remove.
5. Insert new element and screw in place with spanner until tight.
6. Feed element cable back through bracket hole, and refit push-on cap. Towel Rail is now ready to be re-installed.

Please note:

Hydrotherm advise that the unit be removed from the wall and turned upside down to ensure that water does not spill. Ensure element always remains at bottom of Towel Rail if being installed vertically.

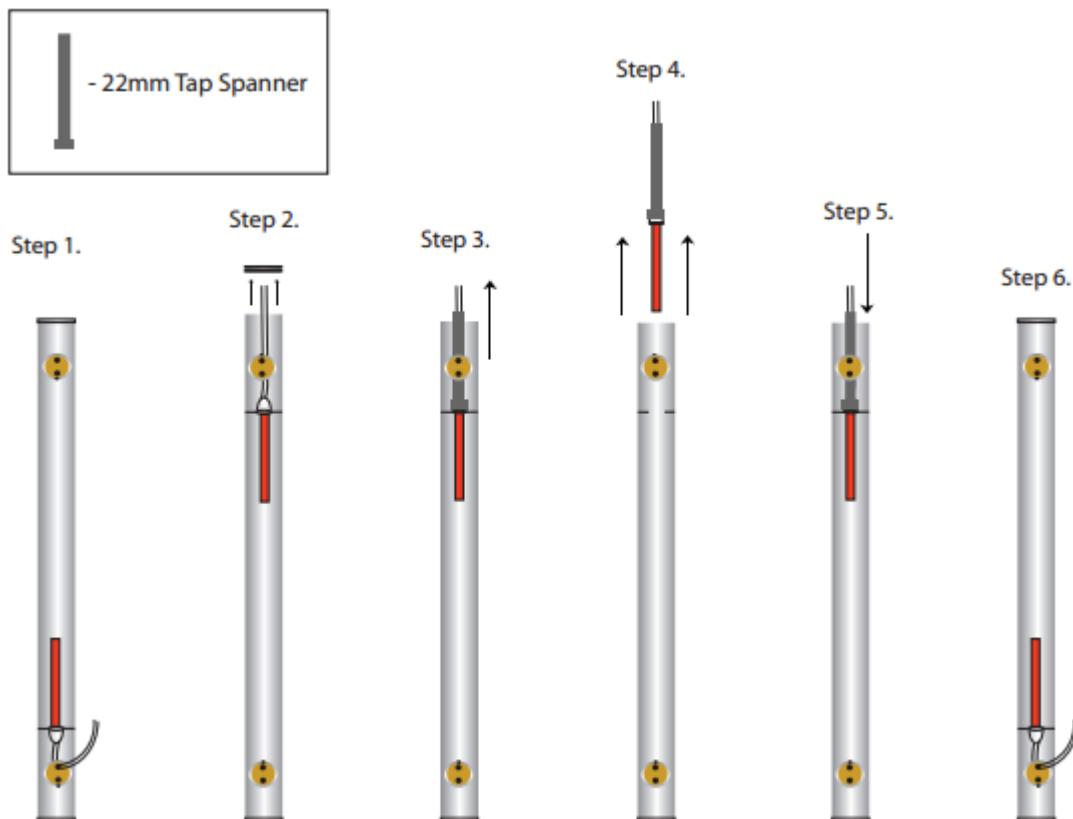



HARD WIRING

Hydrotherm recommends that all hard-wired heated towel rails be connected to a light switch or timer.

Connecting hard-wired heated towel rails to a light switch or timer will prolong the life of the electric element and reduce energy consumption.

Hydrotherm recommend the brand HPM and the model XLP770TRT, this particular unit is designed specifically for heated towel rails that is incorporated into a light switch panel.



HYDROTHERM WARRANTY

At Hydrotherm we pride ourselves on the highest quality standards of design and manufacturing.

All Hydrotherm products come with a 10 year manufactures warranty on the construction and finish of our towel rails.

All electric heating elements are also covered by a 3 year manufactures warranty.



year

Construction & Finish
Manufacturers Warranty



year

Electric Element
Manufacturers Warranty

100% Australian Made and Owned

CARE DETAILS

This bathroom product should not be cleaned with abrasive materials eg. steel wool/scourers. Do not use any corrosive or abrasive cleaning agents containing acids or scouring agents. Bleaches can also discolour products and therefore should not be used. Damage caused by any improper treatment is not covered by the product warranty.

Disclaimer: Products in this specification manual must by regulation be installed by licensed and registered trade people. The manufacturer/distributor reserves the right to vary specifications or delete models from their range without prior notification. Dimensions are nominal measurements only. Dimensions and set-outs listed are correct at time of publication however the manufacturer/distributor takes no responsibility for printing errors.