

The last bastion of privacy, a space of peace and tranquillity, your Bathroom  
Enjoy the look and feel of our European Bathroom fittings and fixtures.  
Designed and made to the highest International and Australian standards.



*architetto*  
Designer Hardware

SYDNEY

Woollahra  
163 Edgecliff Road  
Woollahra NSW 2025  
T 02 9386 9809

Crows Nest

113A Willoughby Road  
Crows Nest NSW 2065  
T 02 9460 6111

MELBOURNE

Richmond  
229 Swan Street  
Richmond VIC 3121  
T 03 9428 9996

QUEENSLAND

Fortitude Valley  
Shop 2, 826 Ann Street  
Fortitude Valley QLD 4006  
T 07 3852 6363

## SINGLE HEATED TOWEL BAR

Code: RNDS-02  
Size: 650x 90 x32 mm  
Material: 304 Grade Stainless Steel  
Finish: Polished  
IP Rating: 55  
Power Usage: 18 Watts  
Power: 120 Watt Transformer can take up to 5 x RNDS-02 Bars  
Transformer Sold Separately – Code: TF-01  
Warranty: 5 Years  
Outlet: **Cable is on the Left Hand side only**

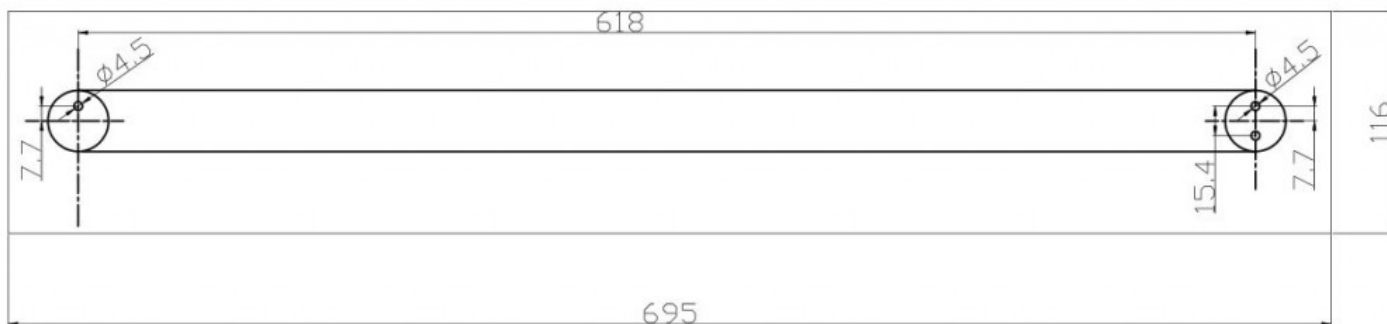

The last bastion of privacy, a space of peace and tranquillity, your Bathroom  
Enjoy the look and feel of our European Bathroom fittings and fixtures.  
Designed and made to the highest International and Australian standards.

## 12 VOLT - Single Bar Towel Rail (Round)

This guide shows the installation of the single bar heated towel rail. Multiple rails can be installed together in any configuration and must be wired in parallel (see wiring diagram). Pre-wiring in the wall cavity or ceiling is required.

- Step 1:** Mark mounting holes according to dimension of rails remembering to also allocate mains electrical supply in wall or ceiling at the mounting points.
- Step 2:** Feed cable coming from the rail, through the hole in the fix bases and then through hole in the wall/ceiling. Connect to 12 volt transformer in the cavity.
- Step 3:** Mount the 2x fix bases into the wall by first inserting the plastic expander and then screwing the ST5\*45 mounting screw.
- Step 4:** Slide the ends of the rails over the fix bases and tighten the M5\*6 mounting screws on the underside with allen key.

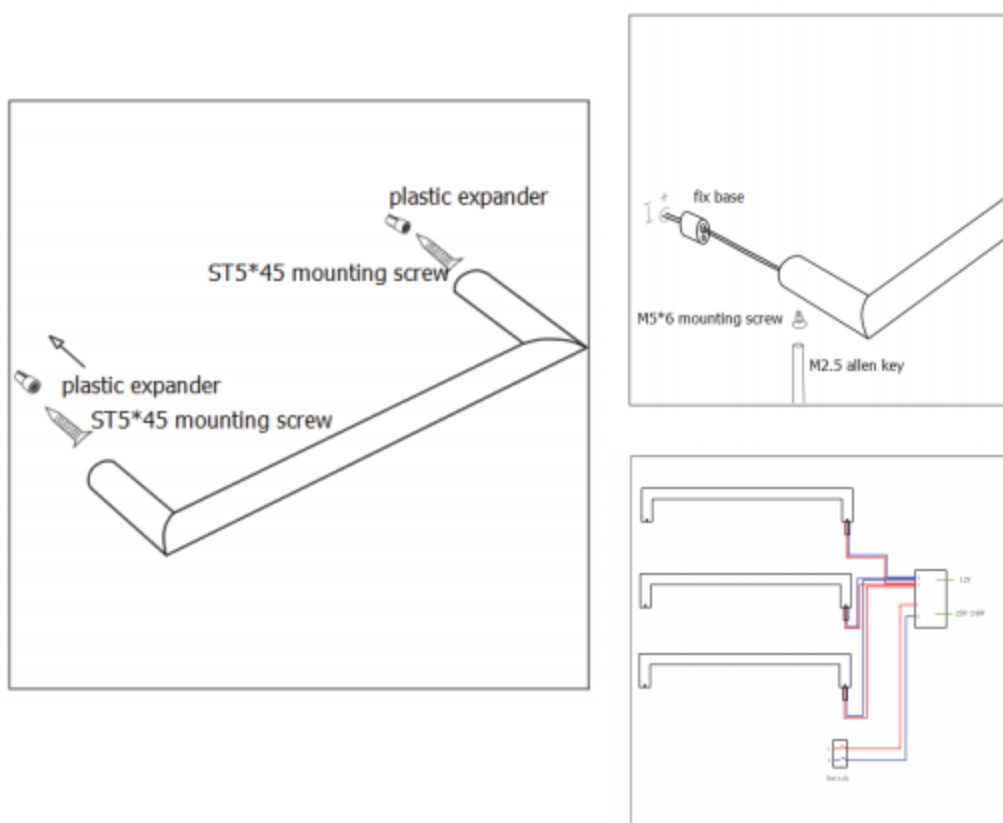

**\*NOTE: Any electrical work must be carried out by a qualified trades person only.**